

Transportation Improvements

Regional transportation planning is a coordinated effort of the metropolitan planning organization (MPO), comprising the counties of Minnehaha and Lincoln, the city of Sioux Falls, the South Eastern Council of Governments, the South Dakota Department of Transportation, the Federal Highway Administration and the Federal Transit Administration. This process assists in the identification of future improvement projects and areas for special study.

A 1995 MPO study was initiated to assess the need for a complete circumferential highway around Sioux Falls. The study concluded that an interstate type beltway was not justified based on area growth projections. However, the study did identify a need for a system of limited access high speed arterial roads to serve the city's projected growth areas. This system will typically develop on the network of section line roads which currently exist beyond the present city limits. The county will play an important role in the development of this system by preserving future rights-of-way, controlling the number of access points, and in some cases initiating improvements on road segments prior to annexation.

A majority of the county's highway construction program involves projects that expand the arterial system beyond the current Sioux Falls city limits. There is presently a need to improve some existing local roads on the periphery of Sioux Falls which carry significant volumes of traffic associated with the urban center. These roadways will complement the city's arterial street system and be developed as part of the metropolitan area transportation planning process.

The Development Plan reserves a large share of the rural area outside the year 2015 Sioux Falls growth area for agricultural use. Highway improvement projects in this area will consist mainly of upgrading existing gravel roads currently on the county system. This will provide a strong network of rural highways to support the agricultural sector and freestanding communities of the county.

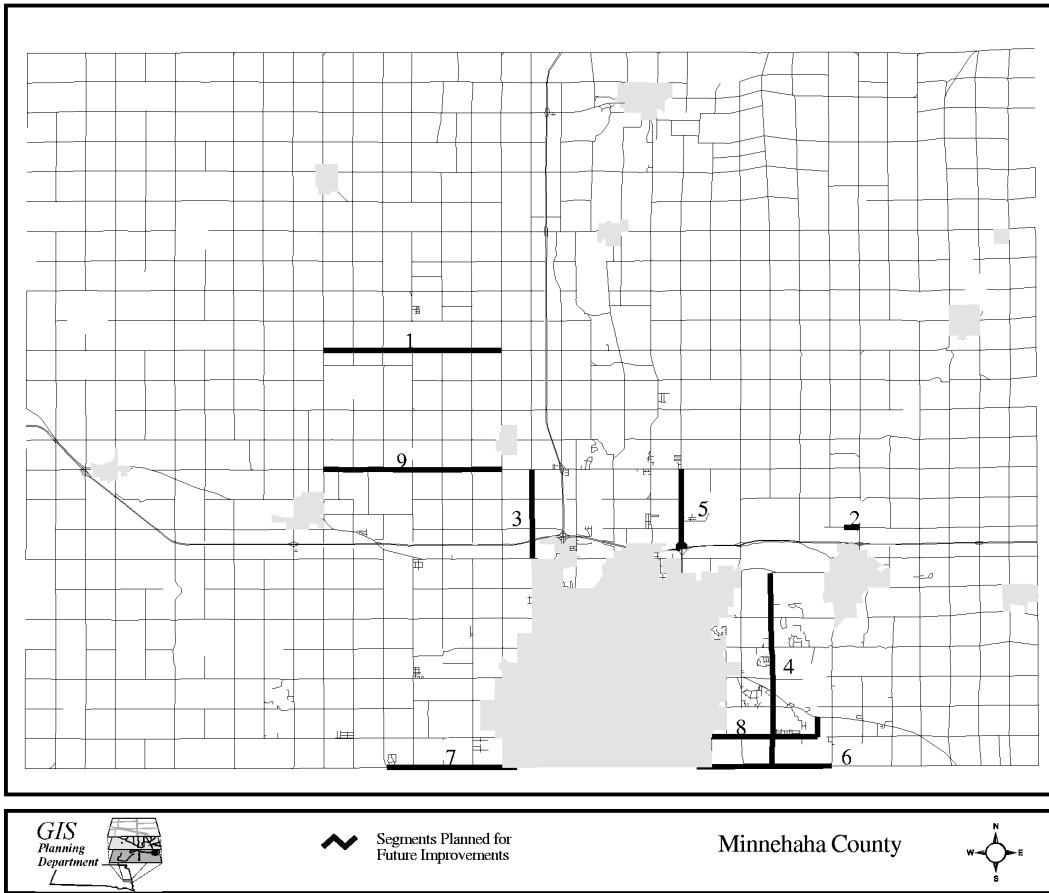

Future Transportation Improvement Projects (project locations are identified on Map 8)

- 1) Realignment/reconstruction of County Highway 122.
- 2) 260th Street (Hwy. 11 west in Corson).
- 3) Marion Road (60th St. N. to 258th St.).
- 4) Six Mile Road (57th St. to Rice St.).
- 5) 476th Street (I-90/I-229 interchange to 258th St.).
- 6) 57th Street (Sioux Falls east across the Big Sioux River, including new bridge).
- 7) 57th Street (Sertoma Ave. to Hwy. 17.).
- 8) 41st Street (Sioux Falls east to Riverview Ave. and north to Hwy. 42).
- 9) Asphalt surfacing of existing gravel roads on county highway system.